



CONTENTS



YOU ARE IN SAFE HANDS.



WHY VADO?

We don't compromise on our design or manufacturing – superior quality taps, showers and accessories are our passion. From product design to our seven step hand polishing process, we manufacture our products to last, so whichever range you choose, outstanding quality comes as standard.

VADO products are expertly designed in Cheddar, England, the home of our brand for the last three decades. We are experts in the brassware industry and take pride in our heritage and values. We ensure only the finest materials are crafted into products that not only look premium, they feel it too.

H2ECO

VADO has a renowned reputation for creating products that deliver the best possible user experience, yet use water sustainably. Wherever you see this symbol  you can be assured that you can use less water without hampering your product's performance or design.* Save water in style with **VADO**.

We all aspire to do what we can to help protect the environment. By fitting **VADO** H2Eco flow regulators to your taps and showers, you can help reduce your carbon footprint.

SAVE WATER
SAVE MONEY
SAVE THE
PLANET.

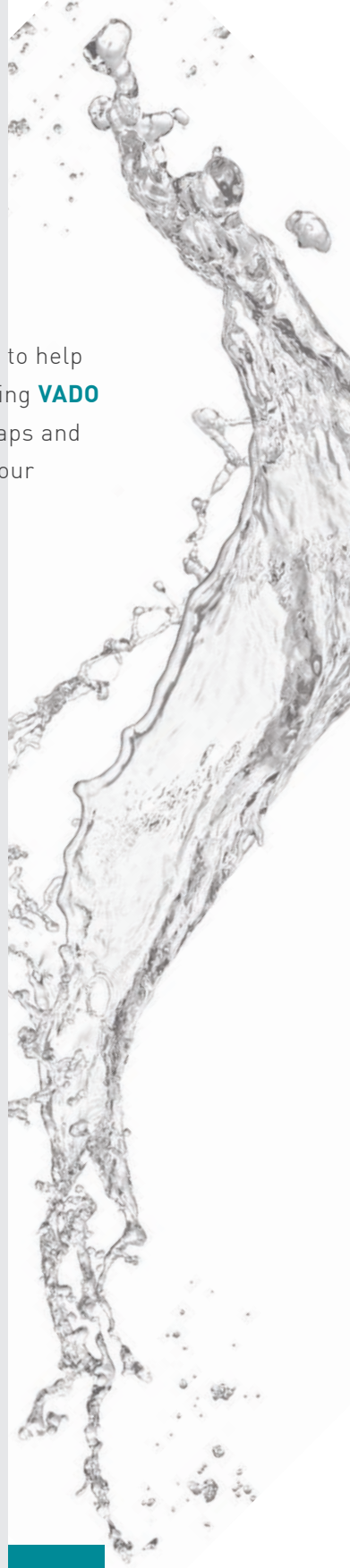



○ Burj Khalifa, Dubai, UAE

DON'T JUST TAKE OUR WORD FOR IT.

VADO products are in some of the most prestigious hotel, commercial and residential developments across the world. This cityscape shows a small snapshot of a variety of prestigious projects we have been involved with.

The exceptional quality of our products, outstanding customer service and our agility to support large scale developments makes **VADO** a globally trusted brand.

JW Marriott Marquis, Dubai, UAE ○

○ Central Market, Abu Dhabi, UAE

Serena Hotel, Kampala, Uganda ○

AND MORE...

- **Marine Wharf**, London, UK
- **One Angel Square**, Manchester
- **Hilton Park Lane**, London
- **Marriott Royal Hotel**, Bristol
- **Montevetro Building**, Dublin
- **Mann Island**, Liverpool
- **Halcyon Holiday Homes**, UK
- **Barge Maria**, London, UK
- **El Pasha Hotel**, Ibiza
- **Al Manshar Rotana Hotel**, Kuwait
- **Ocean 2 Hotel**, Barbados
- **Sheraton Hotel**, Warsaw
- **Marriott Hotel**, Baku
- **Angaga Island Resort**, Maldives
- **Chedi Hotel**, Oman
- **Intercontinental Resort**, Mauritius
- **Eastern & Oriental Hotel**, Malaysia
- **Saman Villas**, Sri Lanka
- **The Pearl**, Doha, Qatar
- **Palm Jumeirah**, Dubai
- **Palazzo Versace**, Dubai

To see the full list please visit vado.com/projects

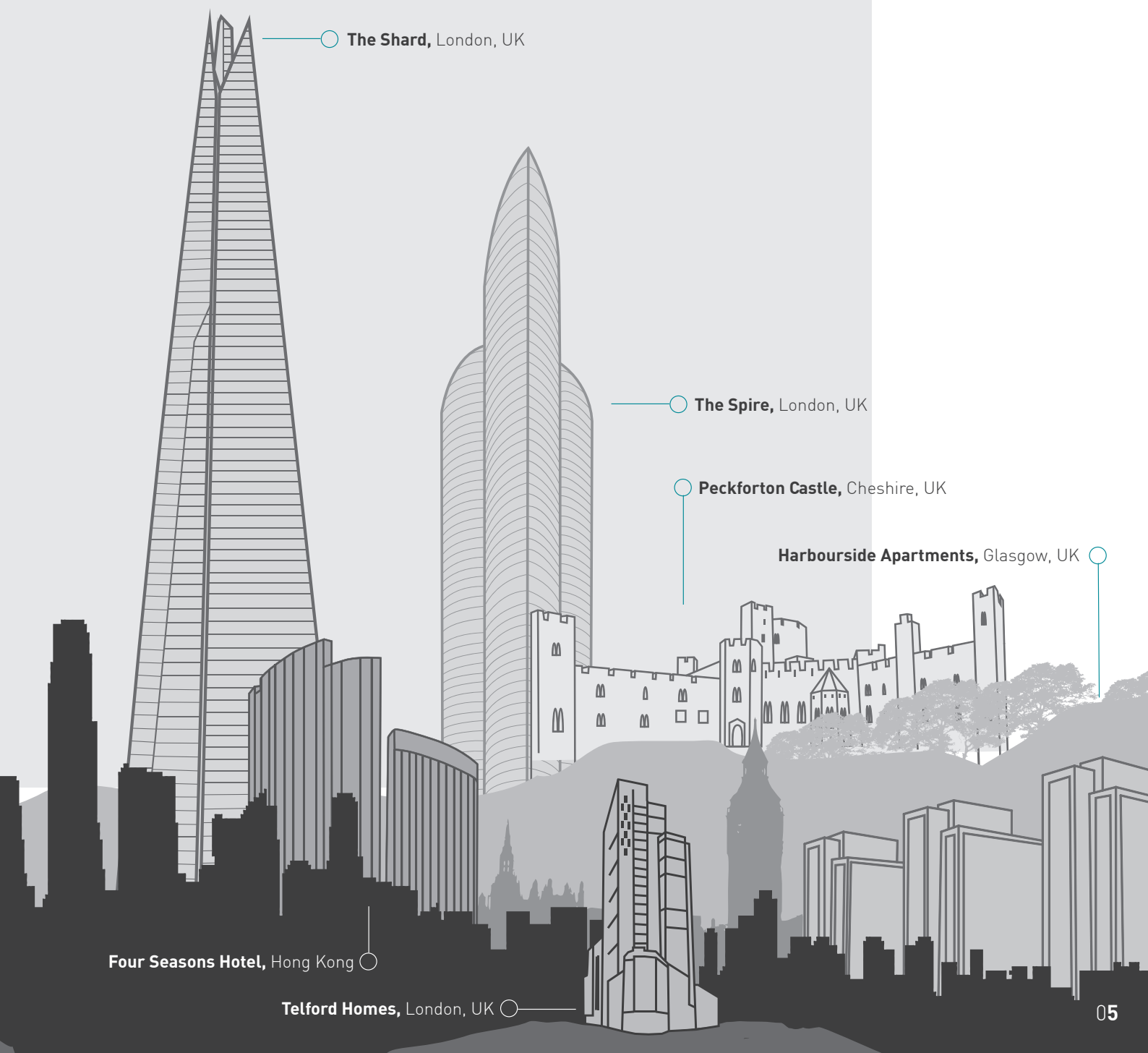

○ The Shard, London, UK

○ The Spire, London, UK

○ Peckforton Castle, Cheshire, UK

Harbourside Apartments, Glasgow, UK ○

Four Seasons Hotel, Hong Kong ○

Telford Homes, London, UK ○



TÉ

VADO

TÉ

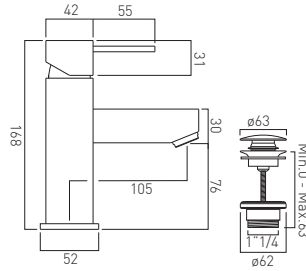

mono basin mixer
with universal waste
0.2 bar LP
TE-100/CC-C/P
Eco **FR-100/5-PLA**

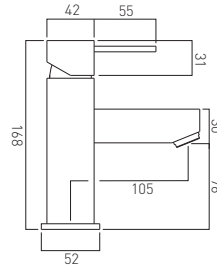

mono basin mixer
0.2 bar LP
TE-100/SB-C/P
Eco **FR-100/5-PLA**

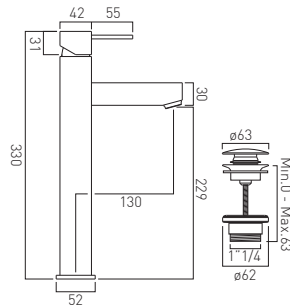

extended mono basin mixer
with universal waste
0.2 bar LP
TE-100E/CC-C/P
Eco **FR-100/5-PLA**

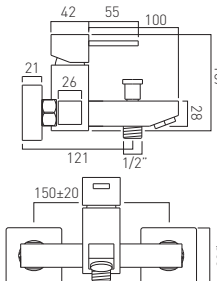

wall mounted bath
shower mixer
1.0 bar MP
TE-123-C/P
Eco **FR-SHOWER/9-C/P**
for showering options
see page 28

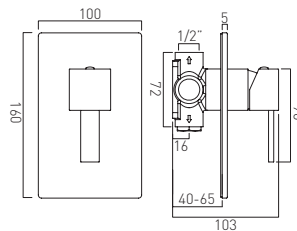

concealed shower valve
0.2 bar LP (shower)
1.5 bar MP (bath)
TE-145A-C/P

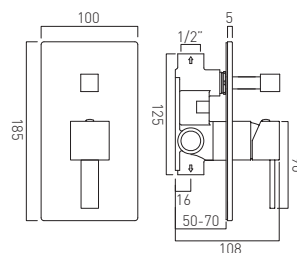

concealed shower
valve with diverter
0.2 bar LP (shower)
1.5 bar MP (bath)
TE-147A-C/P



VICTORIANA



VICTORIANA

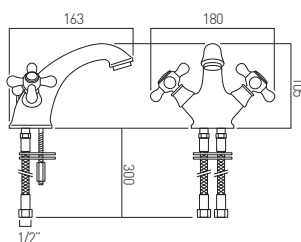

mono basin mixer
with pop-up waste
0.2 bar LP
VIC-100/CD-C/P
Eco **FR-100/5-PLA**

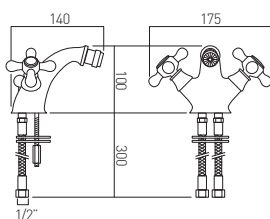

mono bidet mixer
with pop-up waste
0.2 bar LP
VIC-110/CD-C/P
Eco **FR-100/5-PLA**

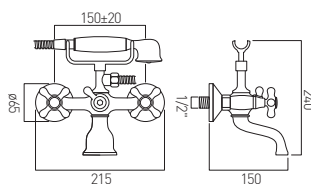

exposed bath shower mixer
with shower kit
0.2 bar LP
VIC-120/CD-C/P
Eco **FR-SHOWER/9-C/P**



CHELSEA

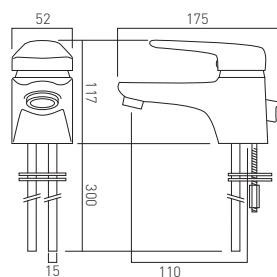

mono basin mixer
with pop-up waste
0.2 bar LP

CHE-100-C/P

FR-100/5-PLA

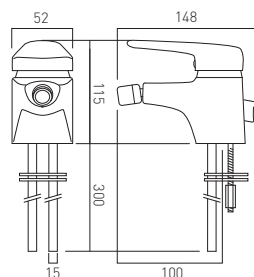

mono bidet mixer
with pop-up waste
0.2 bar LP

CHE-110-C/P

FR-100/5-PLA

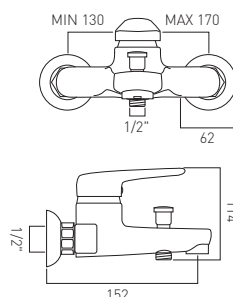

wall mounted bath
shower mixer

1.5 bar MP

CHE-123-C/P

FR-SHOWER/9-C/P



for showering options
see page 28

CHELSEA

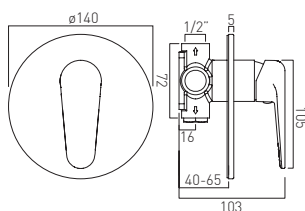

concealed shower valve
0.2 bar LP (shower)
1.5 bar MP (bath)
CHE-145A-C/P

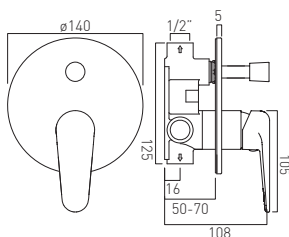

concealed shower valve with diverter
0.2 bar LP (shower)
1.5 bar MP (bath)
CHE-147A-C/P

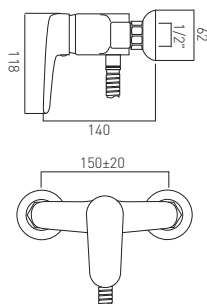

exposed shower valve
0.2 bar LP
CHE-149-C/P

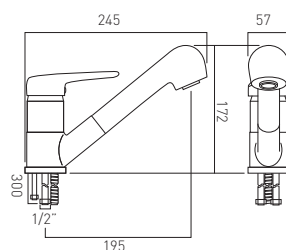

mono sink mixer
with swivel pull-out spout
1.0 bar MP
CHE-152-C/P
Eco FR-FLEXI/5-PLA
(2 Are Required)

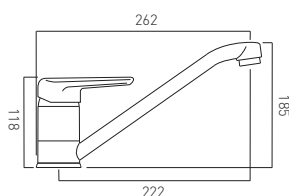

mono sink mixer
with swivel spout
0.2 bar LP
CHE-150-C/P
Eco FR-100/5-PLA

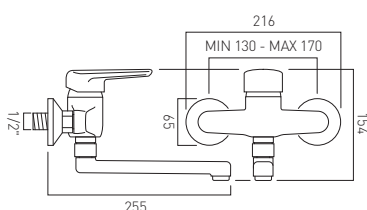

exposed sink mixer
with swivel spout
0.2 bar LP
CHE-154-C/P



MATRIX

VADO

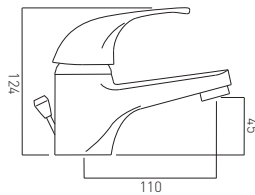

mono basin mixer
with pop-up waste
0.2 bar LP

MAT-100-C/P

FR-100/5-PLA

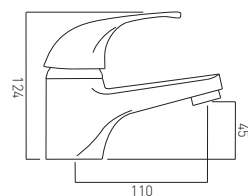

mono basin mixer
0.2 bar LP

MAT-100/SB-C/P

FR-100/5-PLA



MATRIX

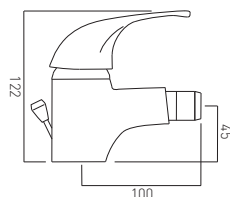

mono bidet mixer
with pop-up waste
0.2 bar LP
MAT-110-C/P
Eco FR-100/5-PLA

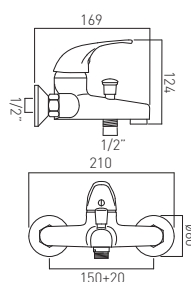

wall mounted bath
shower mixer
1.5 bar MP
MAT-123-C/P
Eco FR-SHOWER/9-C/P
for showering options
see page 28

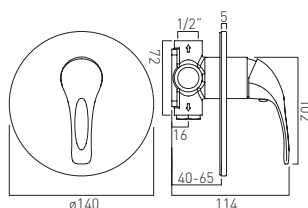

concealed shower valve
0.2 bar LP (shower)
1.5 bar MP (bath)
MAT-145A-C/P

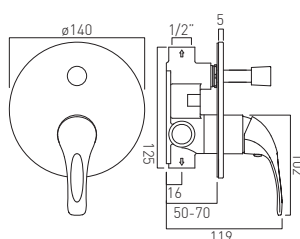

concealed shower
valve with diverter
0.2 bar LP (shower)
1.5 bar MP (bath)
MAT-147A-C/P

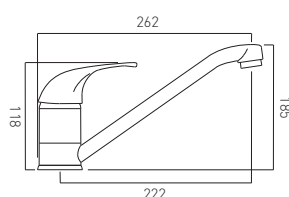

mono sink mixer
with swivel spout
0.2 bar LP
MAT-150-C/P
Eco FR-100/5-PLA





WHY VADO V?

The new **VADO V** collection means customers no longer need to compromise on style or performance when it comes to buying **value for money** bathroom brassware.

The **VADO V** collection has been through the same rigorous development and testing procedures as **VADO** products, offering complete reassurance and peace of mind when it comes to longevity of life.

We have engineered this range to offer incomparable quality and functionality at an affordable price. Designed and developed to provide simplicity and ease of use for the end user, the collection is pared back, offering minimalist and mainstream aesthetics to suit a wide range of tastes.



The **VADO V** collection is both British designed and engineered to ensure product performance is not compromised – a key highlight that sets this range apart from other value brassware products.



KORE



KORE

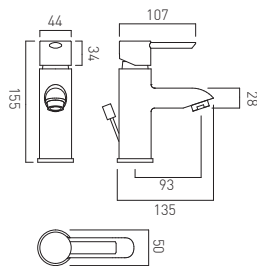

mono basin mixer
with pop-up waste
0.2 bar LP

KOR-100

FR-100/5-PLA

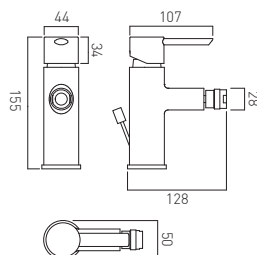

mono bidet mixer
with pop-up waste
0.2 bar LP
KOR-110

FR-100/5-PLA

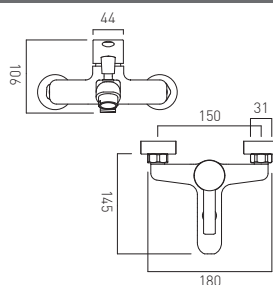

wall mounted
bath shower mixer
1.0 bar MP
KOR-123

FR-SHOWER/9-C/P

for showering options see page 28

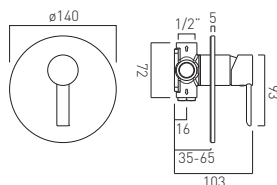

concealed shower valve
0.2 bar LP (shower)
1.5 bar MP (bath)
KOR-145A

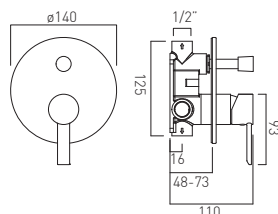

concealed shower valve
with diverter
0.2 bar LP (shower)
1.5 bar MP (bath)
KOR-147A

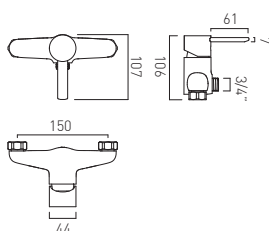

exposed shower valve
0.2 bar LP
KOR-149



VALA



VALA

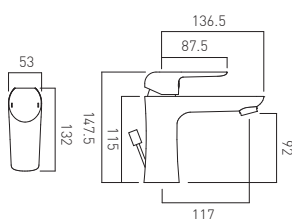

mono basin mixer
with pop-up waste
0.2 bar LP

VAL-100

FR-100/5-PLA

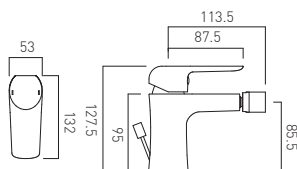

mono bidet mixer
with pop-up waste
0.2 bar LP
VAL-110

FR-100/5-PLA

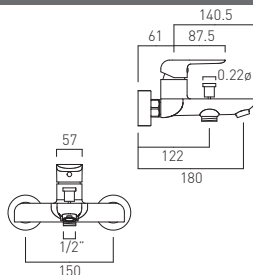

wall mounted
bath shower mixer
1.0 bar MP

VAL-123

FR-SHOWER/9-C/P

for showering options see page 28

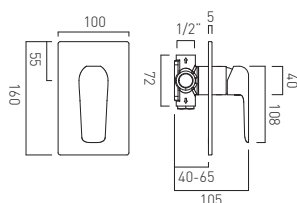

concealed shower valve
0.2 bar LP (shower)
1.5 bar MP (bath)
VAL-145A

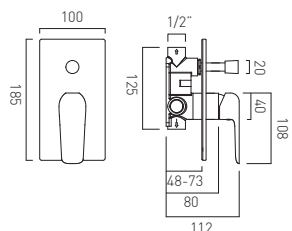

concealed shower valve
with diverter
0.2 bar LP (shower)
1.5 bar MP (bath)

VAL-147A

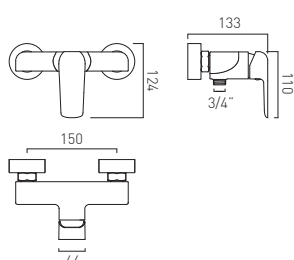

exposed shower valve
0.2 bar LP

VAL-149

PROJECT LINE

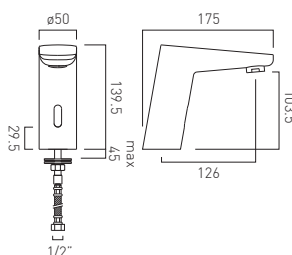

ascent infra-red

mono basin mixer
mains or AA
battery operated
1.0 bar MP
IR-100/ASC-C/P

FR-100/5-PLA

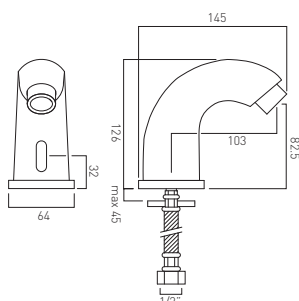

project line infra-red

mono basin mixer
mains or AA
battery operated
1.0 bar MP
IR-100/PRO-C/P

FR-100/5-PLA

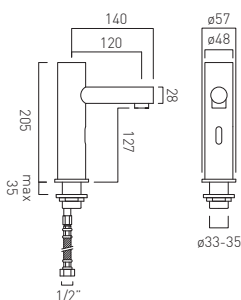

zoo infra-red

mono basin mixer
mains or AA
battery operated
1.0 bar MP

IR-100/ZOO-C/P

FR-100/5-PLA

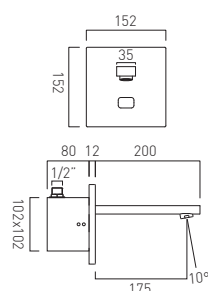

notion infra-red

basin mixer
mains or AA
battery operated
1.0 bar MP
IR-109/NOT-C/P

FR-100/5-PLA



PROJECT LINE

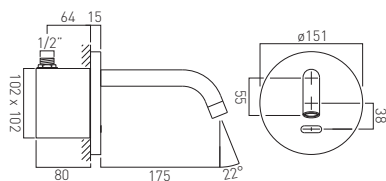

zoo infra-red

basin mixer
mains or AA
battery operated
1.0 bar MP
IR-109/ZOO-C/P
Eco FR-100/5-PLA

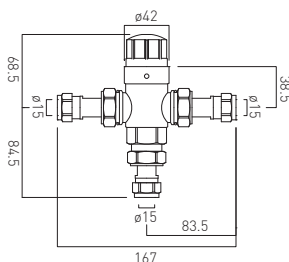

protherm in-line

thermostatic valve, TMV2 approved
supplied with 15mm fittings
0.2 bar LP
PRO-5001-N/P



22mm fittings available to purchase
separately PRO-5001/C-22MM

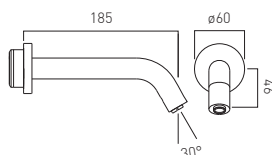

infra-red spout

mains or AA
battery operated
1.0 bar MP
IR-WSPOUT-C/P
Eco FR-FLEXI/4-PLA

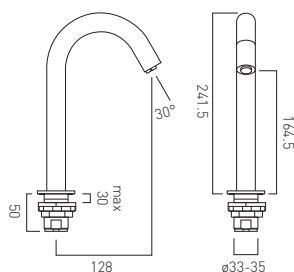

infra-red spout

mains or AA
battery operated
1.0 bar MP
IR-DSPOUT-C/P
Eco FR-FLEXI/4-PLA

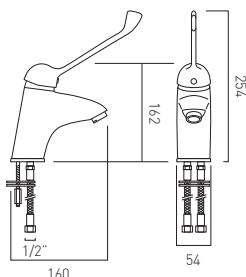

medical mixer
0.2 bar LP
PRO-300-C/P

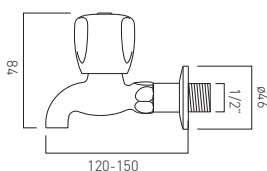

bibtap
0.2 bar LP

wall mounted 100mm
WAR-262/CD-10-C/P

wall mounted 150mm
WAR-262/CD-15-C/P

KITCHEN MIXERS

VADO

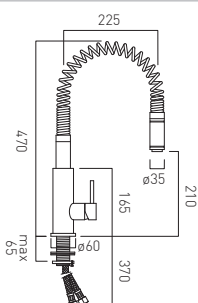

eli

mono sink mixer
with swivel pull-out
spout

1.0 bar MP

CUC-3001-C/P

FR-100/5-PLA

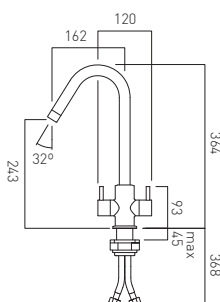

sky

mono sink mixer
with swivel spout
0.2 bar LP

CUC-1060-C/P

FR-100/5-PLA



KITCHEN MIXERS

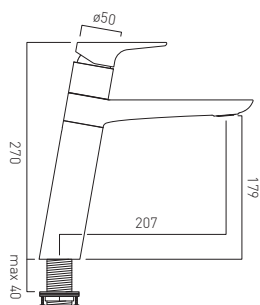

ascent

mono sink mixer
with swivel spout

0.2 bar LP

ASC-150-C/P

FR-100/5-A-PLA

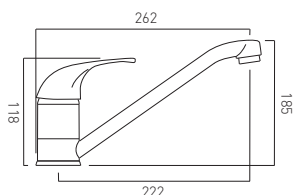

matrix

mono kitchen mixer
with swivel spout

0.2 bar LP

MAT-150-C/P

FR-100/5-PLA

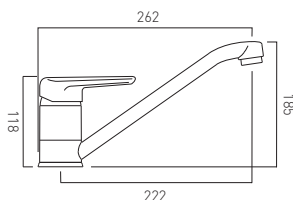

chelsea

mono kitchen mixer
with swivel spout

0.2 bar LP

CHE-150-C/P

FR-100/5-PLA

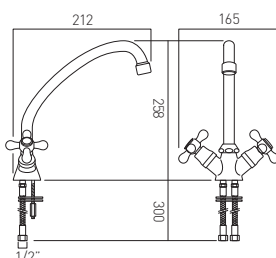

victoriana

mono kitchen mixer
with swivel spout

0.2 bar LP

VIC-150-C/P

FR-100/5-PLA

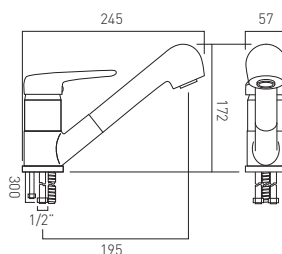

chelsea

mono kitchen mixer
with swivel spout
and pull-out hand spray

0.2 bar LP

CHE-152-C/P

FR-100/5-PLA

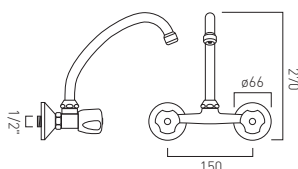

warwick

wall mounted 2 hole
kitchen mixer with
swivel spout

0.2 bar LP

WAR-254G/CD-C/P

WASTES & FITTINGS

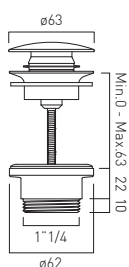

universal brass clic-clac
or free-flow basin waste

WG-395-C/P

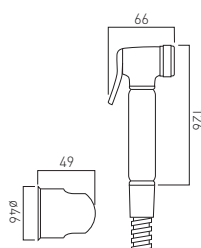

luxury brass shattaf handset,
hose and wall bracket
1.0 bar MP

XSH-LUXSHATTAF/SB-C/P

WASTES & FITTINGS

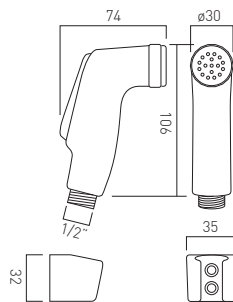

shattaf kit
1.0 bar MP
chrome
PEX-SHATTAF-C/P
Eco FR-SHOWER/9-C/P

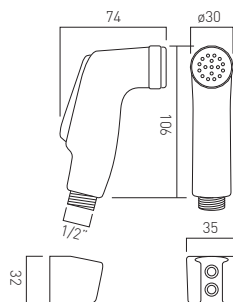

shattaf kit
1.0 bar MP
black/chrome
PEX-SHATTAF-B/C
Eco FR-SHOWER/9-C/P

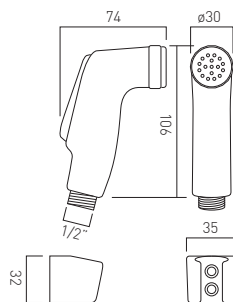

shattaf kit
1.0 bar MP
white/chrome
PEX-SHATTAF-W/C
Eco FR-SHOWER/9-C/P

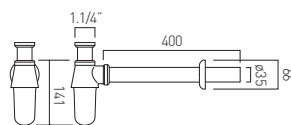

bottle trap
1.1/4" x 1.1/4"
PEX-460-1.1/4-C/P

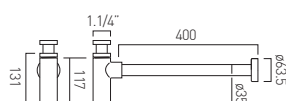

contemporary bottle trap
1.1/4" x 1.1/4"
PEX-461-1.1/4-C/P

ANGLE VALVES

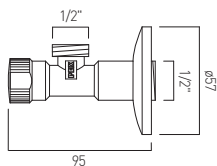

angle valve
1/2" x 1/2"
PEX-225A-C/P

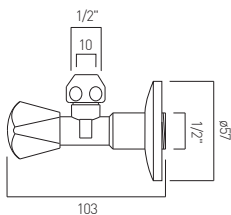

luxury angle valve
1/2" x 1/2" threaded
male outlet
PEX-226A-C/P

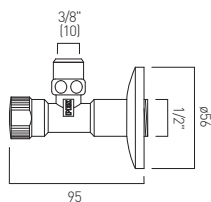

angle valve
1/2" x 3/8"
(10mm compression)
PEX-228A-C/P

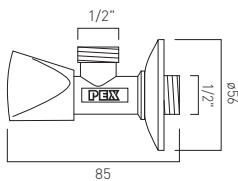

angle valve
1/2" x 1/2"
PEX-229FA-C/P

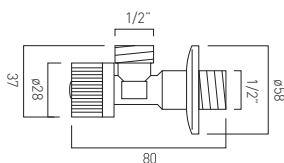

angle valve
1/2" x 1/2"
PEX-233A-C/P



ANGLE VALVES

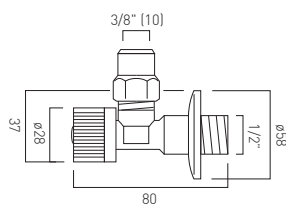

angle valve
1/2" x 3/8"
(10mm compression)
PEX-234A-C/P

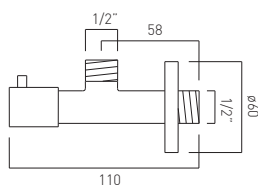

contemporary angle
valve quarter turn
including integral filter
1/2" x 1/2"
PEX-230-C/P

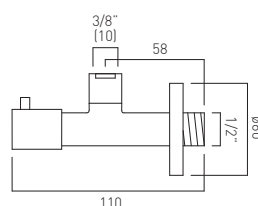

contemporary angle
valve quarter turn
including integral filter
1/2" x 3/8"
(10mm compression)
PEX-221-C/P

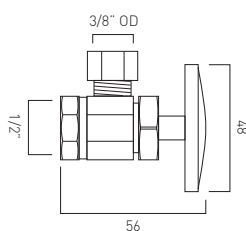

american angle valve
1/2" x 3/8"
(10mm compression)
PEX-231-C/P

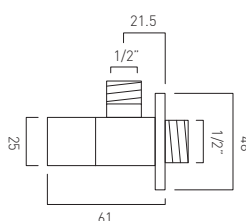

square angle valve
quarter turn
1/2" x 1/2"
PEX-232-C/P

SHOWERING



SHOWERING

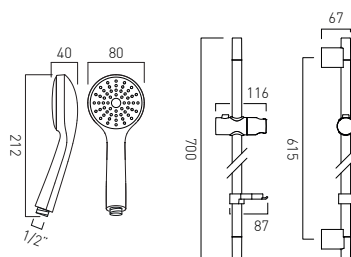

eris

single function rub-clean handset with
700mm slide rail and 150cm shower
hose and hose retainer
function: rain
0.2 bar LP

ERI-SFSRK-DB-C/P

FR-SHOWER/9-C/P

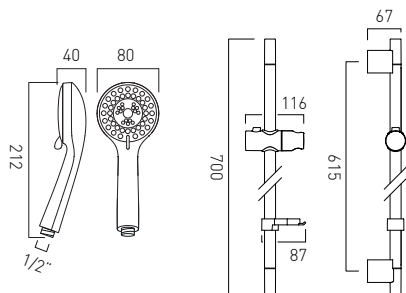

eris

3 function rub-clean handset with
700mm slide rail and 150cm shower
hose and hose retainer
functions: massage, intense rain, rain
0.2 bar LP

ERI-MFSRK-DB-C/P

FR-SHOWER/9-C/P

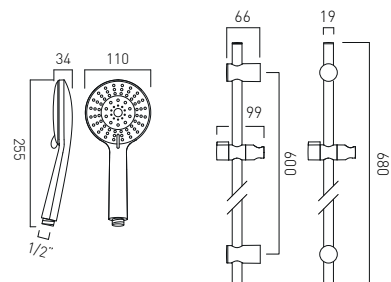

evolve

4 function rub-clean handset with
680mm slide rail and 150cm shower
hose and hose retainer
functions: massage, intense rain, fine
rain, mist
0.2 bar LP

EVO-MFSRK-DB-C/P

FR-SHOWER/9-C/P

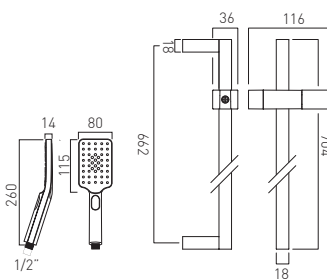

nebula

3 function push button control rub
clean handset with 680mm slide rail
and 150cm shower hose
functions: intense rain, rain, mist
1.0 bar MP

NEB-MFSRK/SQ-DB-C/P

FR-SHOWER/9-C/P

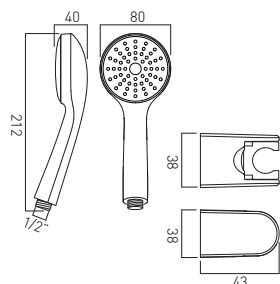

eris

single function rub-clean handset
with 150cm hose and bracket
function: rain
0.2 bar LP

ERI-SFMK-C/P

FR-SHOWER/9-C/P

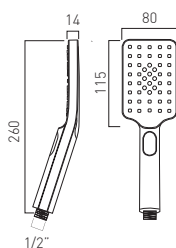

nebula

3 function push button control rub
clean handset functions:
intense rain, rain, mist
1.0 bar MP

NEB-HANDSET-SQ-DB-CP

FR-SHOWER/9-C/P



SHOWERING

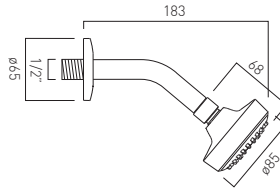

single function fixed
shower head and arm
0.2 bar LP
WG-SFKIT2-C/P
Eco FR-SHOWER/9-C/P

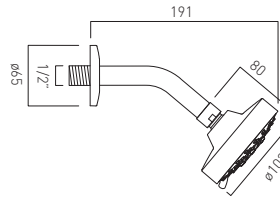

5 function fixed shower
head and arm
1.0 bar MP
WG-MFKIT2-C/P
Eco FR-SHOWER/9-C/P

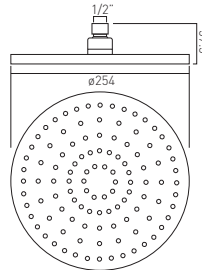
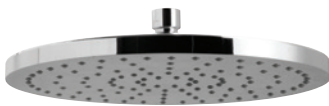

saturn
single function round fixed disc
shower head 254mm (10")
0.2 bar LP
WG-SATURN2-C/P
Eco FR-SHOWER/9-C/P

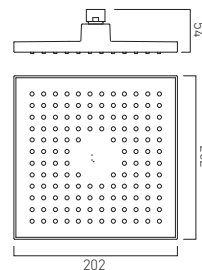

saturn
single function square
shower head 202mm (8")
0.2 bar LP
WG-SATURN2/SQ-C/P
Eco FR-SHOWER/9-C/P

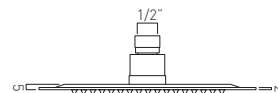
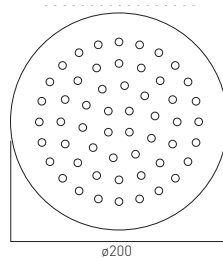

aquablade
single function slimline
easy clean round shower
head 200mm (8")
0.2 bar LP
AQB-RO/20-C/P
Eco FR-FLEXI/9-C/P

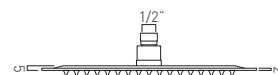
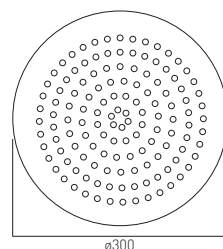
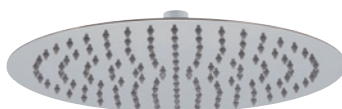

aquablade
single function slimline
easy clean round shower
head 300mm (12")
0.2 bar LP
AQB-RO/30-C/P
Eco FR-FLEXI/9-C/P



SHOWERING

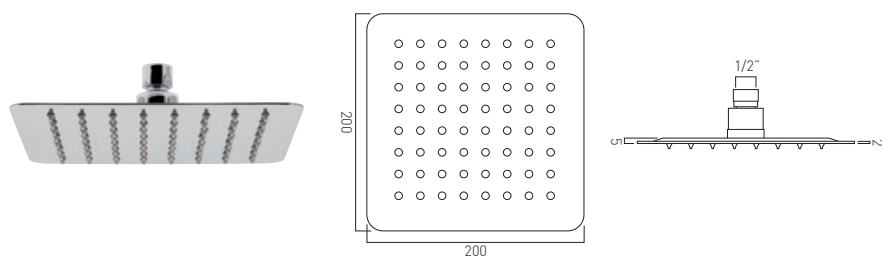

aquablade

single function slimline easy clean
square shower head 200mm (8")

0.2 bar LP

AQB-SQ/20-C/P

Eto FR-FLEXI/9-C/P

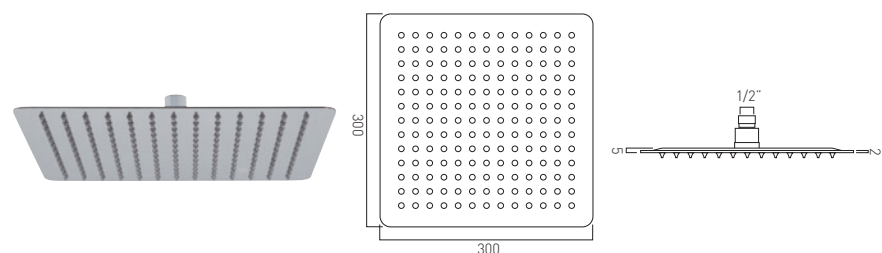

aquablade

single function slimline
easy clean square shower
head 300mm (12")

0.2 bar LP

AQB-SQ/30-C/P

Eto FR-FLEXI/9-C/P



elements

easy fit shower arm

WG-EFSA/RO-C/P

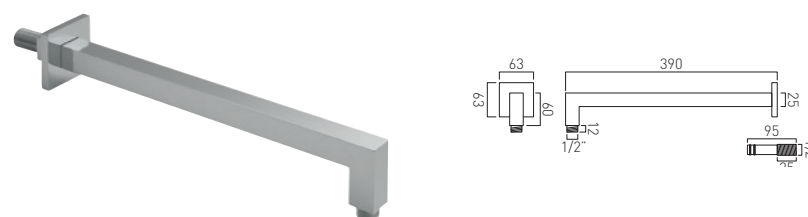

mix²

easy fit shower arm

WG-EFSA/SQ-C/P



traditional

wall outlet
chrome WG-218-C/P

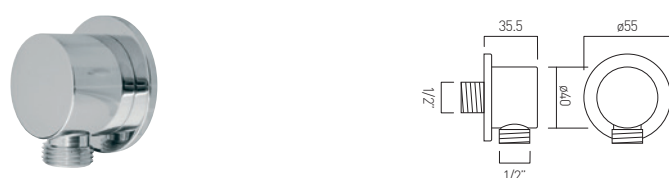

elements

wall outlet

ELE-OUTLET-C/P

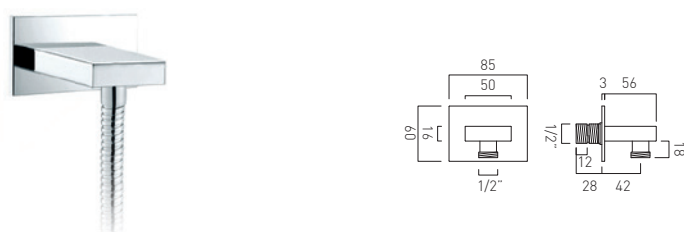

instinct

wall outlet

INS-OUTLET-C/P



ELEMENTS ACCESSORIES

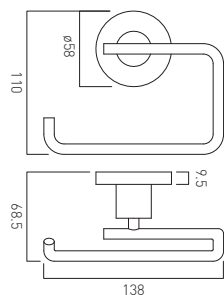

paper holder
ELE-180-C/P

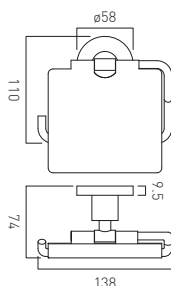

covered paper holder
ELE-180A-C/P

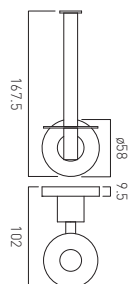

spare paper holder
ELE-180S-C/P

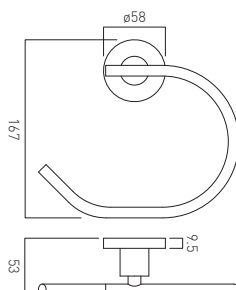

towel ring
ELE-181-C/P

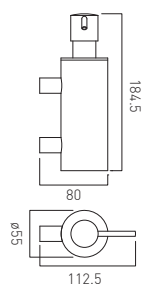

soap dispenser
ELE-182B-C/P

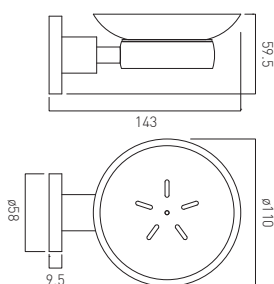

frosted glass soap dish
and holder
ELE-182-C/P

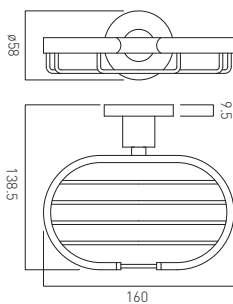
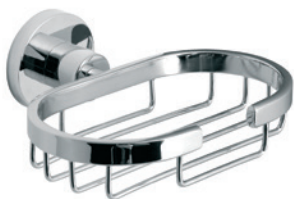

shower basket
ELE-182A-C/P

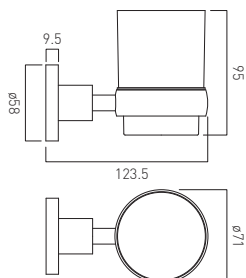

frosted glass tumbler
and holder
ELE-183-C/P

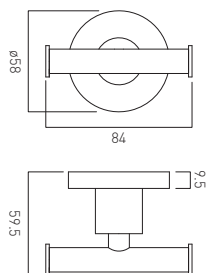

robe hook
ELE-186-C/P



towel rail
695mm (27")
ELE-184-C/P

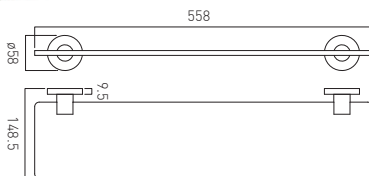

frosted glass shelf
558mm (22")
ELE-185-C/P

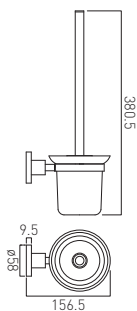

toilet brush and
frosted glass holder
ELE-188-C/P

LEVEL ACCESSORIES

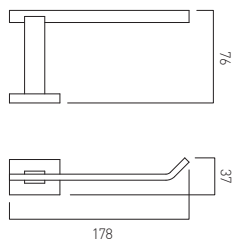

paper holder

LEV-180-C/P

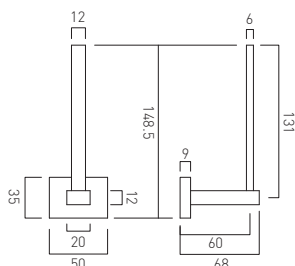

spare paper holder

LEV-180S-C/P

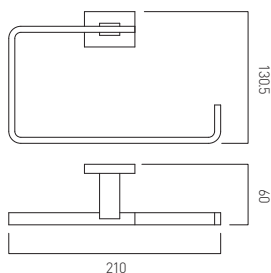

towel ring

LEV-181-C/P

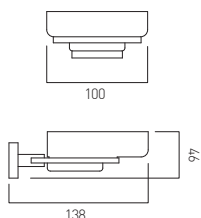

frosted glass soap dish
and holder

LEV-182-C/P

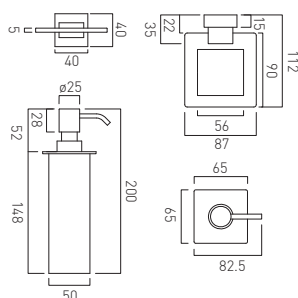

soap dispenser

LEV-182B-C/P

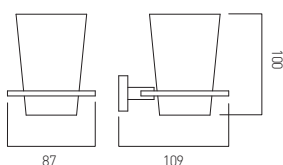
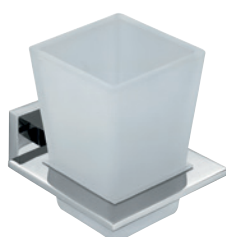

frosted glass tumbler
and holder

LEV-183-C/P

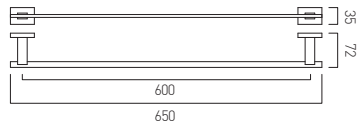

towel rail
650mm (26")
LEV-184-C/P

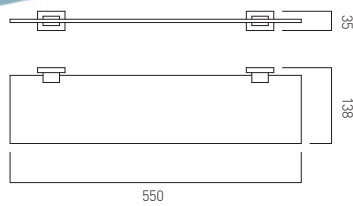

frosted glass shelf
550mm (22")
LEV-185-C/P

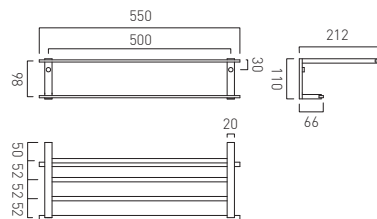

towel shelf with towel rail
550mm (22")
LEV-185B-C/P

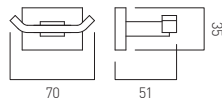

robe hook
LEV-186-C/P

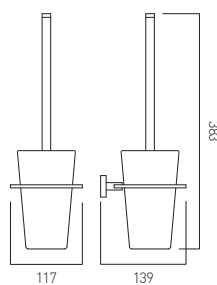

toilet brush and
frosted glass holder
LEV-188-C/P

GUARANTEE



VADO chrome products have a 12 year guarantee



VADO electronic products have a 6 year guarantee



VADO shattaf products have a 5 year guarantee

TERMS AND CONDITIONS

DEFINITIONS

In these conditions 'the Company' shall mean VADO, a division of Norcross (Holdings) Limited, 'the purchaser' shall mean the person, firm or company to whom any quotation is addressed or with whom any contract is made and 'the goods' shall mean the goods and/or services agreed to be sold by the Company to the purchaser.

1. QUOTATION AND ACCEPTANCE

- (a) All quotations are given and all orders are accepted on these terms which shall apply to the exclusion of and shall override any other terms stipulated or referred to by the purchaser whether in its order or any other document, or in any negotiations or communication or course of dealing established between the Company and the purchaser;
- (b) No modification or amendment of these terms or addition thereto shall be effective unless made in writing and signed by a director of the Company.

2. DESCRIPTION OF AND STATEMENTS AS TO GOODS

- (a) Save where the goods are stated to be sold as complying with a recognised trade or industry standard, all descriptions, specifications, drawings and particulars of weights and dimensions submitted by the Company or otherwise contained in the Company's catalogues, brochures, price lists, quotations and publicity materials are approximate only and the Company shall not be liable for their accuracy unless they are expressly incorporated into the contract in writing;
- (b) These terms represent the entire agreement between the Company and the purchaser relating to the goods and such terms supersede and the purchaser shall not place any reliance upon any statements, recommendations and advice whether oral or in writing given (whether before or after the acceptance by the Company of the purchaser's order) by the Company, its servants or agents as to any matter relating to the goods save where such statement, recommendations or advice is given in writing and signed by a director of the Company in response to a specific written request from the purchaser before or at the time of the Company's acceptance of the order.

3. PRICES

- Prices quoted by the Company are those in effect at the date of quotation. Unless otherwise agreed in writing, the Company reserves the right to increase prices when it accepts the purchaser's order so as to reflect one or more of the following:
- (a) any variation that may have occurred in the costs of labour, materials, suppliers overheads and transport;
 - (b) any change in duty, tax, surcharge or levy of any kind whatsoever affecting the sale price of the goods;
 - (c) any cost to the Company resulting from delay by the purchaser in giving to the Company information sufficient to enable it to supply the goods or provide the services or resulting from any alteration made at the request of the purchaser in the specification of the goods or in the place to which they are to be delivered or shipped;
 - (d) any extra cost to the Company resulting from the goods being carried at the request of the purchaser by mode of transport more expensive than the Company's normal form of transport.

4. PAYMENT

- (a) Unless otherwise agreed in writing, the price for the goods will be due and payable on the last business day of the month following delivery;
- (b) The Company shall be entitled to charge interest on any part of the price which is not paid in accordance with clause (a) at the rate per annum of 3% above the Base Rate of Lloyds Banking Group from time to time;
- (c) Time of payment is of the essence and if the purchaser defaults in punctual payment of the price the Company shall be entitled to terminate the contract and recover the goods at the purchaser's expense without prejudice to any further rights which the Company may have;
- (d) Any default in payment of an invoice or an instalment payment on an invoice on the due date shall render the entire balance outstanding on all invoices from the Company to the purchaser immediately payable in full without demand being made notwithstanding any contrary provisions as to terms of payment in any one or all invoices;
- (e) If the purchaser fails to give all instructions reasonably required by the Company and all necessary document, licences, consents and authorities for forwarding the goods or is unable to accept delivery of the goods at the time when the goods are due and ready for despatch or delivery or shall otherwise cause or request delay, the purchaser shall pay to the Company all costs and expenses, including storage and insurance charges incurred or arising from such delay during which, at the Company's absolute discretion if its storage facilities permit, the goods will be stored at the purchaser's sole risk. This provision shall be in addition to and not in substitution for any other payment or damages for which the purchaser may be liable in respect of his failure to take delivery at the appropriate date;
- (f) The purchaser shall not be entitled to make any deduction from the price of goods which have been delivered to the purchaser in respect of any set off or counterclaim unless both the validity and the amount thereof have been expressly admitted in writing by the Company and such admission is signed by a director of the Company;
- (g) In the absence of any specific appropriation by the purchaser, the Company shall have the right to appropriate any payment made by the purchaser towards the satisfaction of any invoice outstanding from time to time as the Company shall in its absolute discretion think fit.

5. DELIVERY

- (a) Any time or date stated for delivery is given and intended as an estimate only and the Company shall not be liable for any loss or damage whatsoever resulting from any delay in delivery howsoever arising;
- (b) Unless otherwise stated in writing delivery shall be deemed to take place upon the occurrence of the first in time of the following, namely:
 - i. the physical delivery of the goods to the purchaser at the Company's works;
 - ii. the physical delivery of the goods to the purchaser's carrier or agent for the purpose of transmission to the purchaser or his nominee;
 - iii. the physical delivery of the goods to the purchaser's place of business or such other place as he may direct by the Company, its carrier or agent, the purchaser being responsible for unloading;
- (c) Signature of the Company's delivery note by any employee, representative or agent of the purchaser shall be conclusive proof of delivery;
- (d) Where the contract provides for delivery by the Company, its carrier or agent:
 - i. any claims for non-delivery must be made in writing to the Company within three days of receipt of invoice or advice note whichever is the earlier;
 - ii. any claims in respect of goods damaged in transit or shortages in delivery must be made in writing to the Company within three days of delivery; shortages in delivery shall not give rise to a right to reject the goods delivered;
- (e) The Company shall be entitled to make partial deliveries or deliveries by instalments and all the provisions of these terms shall apply to such deliveries;

6. PROPERTY AND RISK

- (a) Risk in the goods shall pass to the purchaser at the time at which delivery takes place in accordance with clause 5 above and the purchaser shall be solely responsible for insuring the goods thereafter;
- (b) The Company shall retain ownership of and title in the goods delivered until full payment has been made in respect of all such goods. Until such time the goods shall be:
 - i. stored separately from other goods in the possession of the purchaser;
 - ii. marked or otherwise rendered identifiable as being the property of the Company;held by the purchaser as bailee of the Company;

- iii. held by the purchaser free from any charge, lien or other encumbrance;
 - iv. Provided the Company has not requested their return and notwithstanding that payment in full has not been made for all of the goods delivered, the purchaser as principal and not as agent for the Company shall be entitled to use the goods or offer for sale and sell them in the ordinary course of his business;
- Where the purchaser sells the goods prior to paying for them in full:
- (d) the Company shall be legally and beneficially entitled to the proceeds of sale;
 - i. the purchaser shall hold the proceeds of sale on trust for the Company and shall not mingle them with other monies and shall not pay them into an overdrawn bank account;
 - iii. he shall deposit the proceeds of sale in a separate bank account, the location and number of which he has previously notified to the Company, and he shall not be entitled to use or deal with the proceeds of sale until payment in full for the goods has been made to the Company;
- (e) The Company shall have the right at any time by its servants or agents to enter the purchaser's premises where the goods are stored, or are thought the Company to be stored, so as to:
 - i. retake possession of the goods when the Company has requested their return and the purchaser has not immediately complied with the request, such retaking or return to be without prejudice to any other rights the Company may have arising therefrom;
 - ii. inspect the storage of the Company's goods which have not been paid for in full;
 - iii. investigate and ascertain whether all these terms are being complied with;

7. GUARANTEE AND LIABILITY

- (a) The Company guarantees all goods which have been manufactured by the Company against any defect of work or materials which can be proved to the Company's satisfaction to have been caused before delivery provided that:
 - i. the goods are used for their normal purpose,
 - ii. full details of any such defect are notified to the Company within thirty days of its first appearance and
 - iii. the goods in which the defect arises are returned at the purchaser's expense to the Company;
- (b) The guarantee shall be for a period of twelve years from the date of delivery for all product except pumps which are 3 years for Monsoon and 1 year for Showemate and products with any other finish that is not chrome, such as gold, which are guaranteed for 3 years. The liability of the Company shall be limited at its option either to supply replacement goods, which will be supplied subject to these terms, or refunding of the goods;
- (c) The Company gives no guarantee in respect of goods not manufactured by it but shall use all reasonable endeavours to procure for the purchaser or assign to the purchaser the benefit of any guarantee obtained by it from the manufacturer or supplier thereof; however the Company shall not be required to commence litigation against such manufacturer or supplier or to incur any expense in connection with any such claim by the purchaser;
- (d) The above guarantee is given in lieu of and to the exclusion of all other warranties, conditions, representations and undertakings express or implied by statute or otherwise in respect of the quality or fitness for purpose of the goods or as to their condition or performance or as to any other matter except where such warranty or condition is implied by statute and by reason of a statutory provision, cannot be excluded;
- (e) Save as provided herein and save in any case where death or personal injury has been caused by the Company's negligence or any case where the Company is liable for a defect in the goods pursuant to Part 1 of the Consumer Protection Act 1987 or any statutory replacement thereof, the Company shall be under no liability whatsoever to the purchaser for any loss or damage whether direct, indirect or consequential arising out of any defect in, failure of or unsuitability for any purpose of the goods or any part thereof whether the same be due to any act, omission, breach of contract, negligence or wilful default in design, workmanship or materials or any other cause.

8. INDEMNITY AS TO INDUSTRIAL PROPERTY RIGHTS

- (a) The purchaser shall indemnify the Company against all loss, damages, costs and expenses suffered or incurred by the Company or to which the Company may become liable as a result of any work carried out in accordance with the purchaser's specification(s) which involves infringement or alleged infringement of a patent, registered design or other industrial property right;
- (b) If the purchaser uses or sells the goods in such a manner as to infringe any such rights the company shall not be responsible for such infringement and the purchaser agrees to indemnify the Company from and against all liability arising therefrom.

9. TERMINATION

- The Company shall have the right forthwith to cancel the purchaser's order if any of the following events occur and subject to enforcement of the Company's rights to recover the goods and to receive payment of the price or damages, the contract shall be deemed to have terminated:
- (a) the purchaser commits any breach of its obligations to the Company;
 - (b) any distress or execution is levied upon any property of the purchaser;
 - (c) the purchaser makes or offers to make any arrangement or composition with creditors or commits any act of bankruptcy or insolvency;
 - (d) any resolution is passed or petition presented to wind up the purchaser;
 - (e) a receiver or administrator is appointed or any chargee takes possession of all or any part of the undertaking or assets of the purchaser;
 - (f) the purchaser stops payment or ceases or threatens to cease to carry on its business or to pay its debts as and when they fall due;
 - (g) any remittance for payment of the whole or any part of the purchase price of the goods is dishonoured by the purchaser's bankers.

10. ASSIGNMENT

The purchaser shall not assign or transfer or purport to assign or transfer any contract to which these terms apply to any other person without the Company's prior written consent. The Company reserves the right to subcontract the performance of the contract or any part of it.

11. FORCE MAJEURE

If the Company is prevented or delayed (directly or indirectly) from making delivery of the goods or any part thereof or from otherwise performing the contract or any part thereof by reason of war, embargo, riot, strike, lock-out, trade dispute, fire, breakdown of plant or machinery, inclement weather, interruption of transport, Government action, delay in delivery to the Company of any goods or materials, or by any cause whatsoever (whether or not of a like nature to the foregoing) outside its control, it shall be under no liability whatsoever to the purchaser and shall be entitled at its option either to cancel the contract or without any liability to extend the time or times for delivery by a period equivalent to that during which such delivery has been prevented.

12. PROPER LAW

The contract and these terms shall be governed by English law and the purchaser shall submit to the sole jurisdiction of the English Courts.